

Shock sensors

- Change of the circuit output status in the presence of impact/vibration.
- Prevent the breakage of mechanical actuators in general (linear or rotary).
- Use of the Micro Electro-Mechanical System (MEMS) technology.
- Monitor any system vibration and intervene or solve any malfunctions, as required.
- Special layout to be mounted on all the actuators.
- M8 connector output.

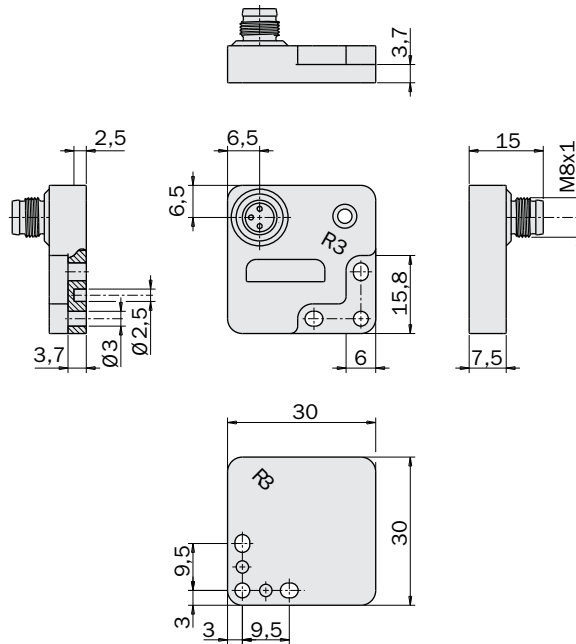

Dimensions (mm)

Application examples



Linear actuators



Cylinders



Grippers

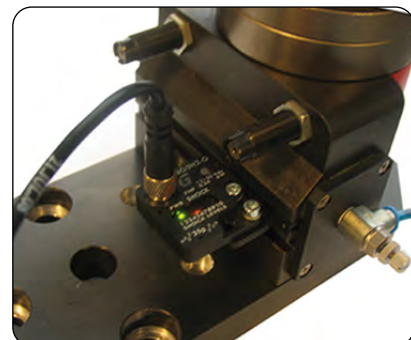

Rotary actuators

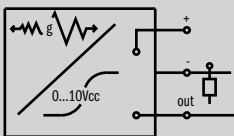
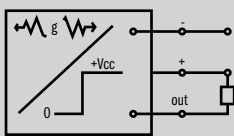
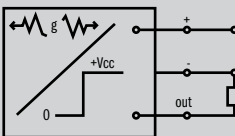
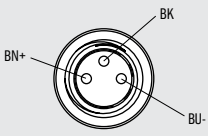
Sensor with M8 male connector	SG3A2-G	SG3N2-G	SG3M2-G
Price	Call Gimatic USA	\$121.00	Call Gimatic USA
Sensor type	Analog output	10-level settable PNP output	10-level settable NPN output
Full scale	35 g		
Vibration axis	X ; Y		
Power supply voltage	15 ± 30 Vdc	12 ± 30 Vdc	
Switching current	max 0.5 A		
Power rating (Ohmic load)	/	6 W	
Nominal switching point	0÷35 g (~270 mV/g)	2.0g; 2.5g; 3.3g; 4.2g; 5.3g; 7.4g; 9.5; 12.2g; 15.6; 20.0g	
Output voltage ON	0 ± 10 Vdc	+ Vcc (PNP)	GND (NPN)
Maximum impact intensity	4000 g		
Time "ON"	/	200 ms	
Switching frequency	100 kHz		
Operating temperature	-10 ÷ 70°C		
Electric service life	10 ⁷ imp.		
Polarity reversal protection	Yes		
Auto-test	Yes		
Protection rating	IP67		
Sensor body materials	PA; AISI 303; OT63; gold plated brass		
CE normative references	EN61000-6-2; EN61000-6-3; EN55022; EN61000-4-2; EN61000-4-3		
Wiring diagrams			
Connection	 <p>Brown BN(+); Blue BU(-); Black BK (OUT)</p>		